

PREMIER SERIES CABINET SPECIFICATIONS

- FRONT FRAME:** 3/4" Thick kiln dried solid hardwood (wood door styles) or thermofoil vinyl wrapped solid finger jointed lumber or LVL linear veneer lumber (thermofoil and laminate door styles). Mortise and tenon or bore and dowel construction frame joinery reinforced with glue and nail. Stiles 1 1/2" wide. Mulls 3" wide. Rails 1 3/4" wide. Stiles and top and bottom rails dadoed to receive ends, tops and bottoms.
- END PANELS:**
Standard: Nominal 1/2" thick (12mm) industrial grade, wood based composite panel dadoed to receive tops and bottoms, with wood grained or white laminate on exterior surface. Maple grained or white laminate on interior surface. All end panels are inserted into dado in face frame and recessed 3/16".
Upgrade Option: Nominal 1/2" thick (12mm) multi-ply hardwood plywood with oak, maple or cherry veneer on exterior surface and birch veneer on interior surface. All end panels are constructed with the same dado joinery as above and are recessed 3/16".
- TOP/BOTTOM PANELS:** Nominal 1/2" thick (12mm) Industrial grade, wood based composite panel with maple grained or white laminate on exterior and interior surfaces for wall cabinets and interior surface for base cabinets.
- HANGING RAILS:** Wall cabinets have nominal 3/4" thick (18mm) x 3" high multi-ply hardwood plywood or 3/4" thick x 3 7/16" high solid lumber with white laminate. Each is running full cabinet length at the top and bottom. Base cabinets have a nominal 1/2" thick (12mm) x 3" high industrial grade composite panel with maple grained or white laminate at the top.
- BACK PANEL:** 1/8" Hardboard with maple grained or white interior surface.
- SHELVES:** Nominal 5/8" thick (15mm) industrial grade wood based composite panel with maple grained or white laminate on both faces and matching edgeband on facing edge. Shelves are adjustable in all standard wall and base cabinets.
- TOE KICK:** Nominal 1/2" thick (12mm) industrial grade, unfinished wood based composite panel captured between end panels.
- BASE CORNER BRACES:** High impact, injection molded plastic.
- DRAWERS:** (Standard) Nominal 1/2" thick (12 mm) solid wood front, back and sides. Drawer bottoms are multi-ply hardwood plywood inserted into dado in front, back and sides. All drawer parts glued and stapled together.
- DRAWER GUIDES:** High quality epoxy coated steel, Cushion-Tec, side mounted guides, self adjusting in mounting brackets. Built-in stop, self-closing and stay-closed features with a 100 lb. rated load capacity.
- DOVETAIL DRAWER:** (Upgrade only) Front, back and sides are nominal 3/4" thick (19 mm) solid beech hardwood with dovetail construction. Drawer bottoms are nominal 3/16" (5 mm) multi-ply hardwood birch plywood inserted into dado in front, back and sides. Drawer bottoms are glued and stapled to sides.
- UNDERMOUNT DRAWER GUIDE:** (Standard with dovetail drawer only) High quality steel, undermount construction provides full drawer access. Self adjusting in mounting brackets. Built-in stop, self-closing and stay closed features with a 75 lb. rated load capacity.
- SOFT-CLOSE UNDERMOUNT DRAWER GUIDE:** (Deluxe upgrade with dovetail drawer only) High quality steel, undermount construction provides soft-close feature that helps reduce drawer slamming. Drawers are full extension, self adjusting in mounting brackets. Built-in stop, self-closing and stay closed features with a 100 lb. rated load capacity.
- HINGES:**
Standard: Heavy duty, high quality steel, concealed 6-way adjustable hinge with self-closing feature.
Optional: High quality steel wrap-around hinge with self closing feature. (Standard reveal door styles only)
- FINISH:** Furniture quality protective finish system on doors, drawer fronts, front frames and veneer plywood end panels consisting of sanding, stain, catalyzed sealer and catalyzed clear top coats.

PREMIER SERIES UPGRADE NOMENCLATURE

- Wall Cabinet with Oak, Maple or Cherry Plywood End Panels: WPEP(priced per cabinet)
 Base Cabinet with Oak, Maple or Cherry Plywood End Panels: BPEP(priced per cabinet)
 Tall Cabinet with Oak, Maple or Cherry Plywood End Panels: TPEP(priced per cabinet)
 Dovetail Drawers (includes undermount guide): DDU(priced per drawer)
 Large Dovetail Drawers (includes soft-close undermount guide): *LDDU(priced per drawer)
 Dovetail Drawers (includes soft-close undermount guide): DDSC(priced per drawer)
 Large Dovetail Drawers (includes soft-close undermount guide): *LDDSC(priced per drawer)
 Glazed Finish Dovetail Drawers (includes soft-close undermount guide): GDDSC(priced per drawer)
 Glazed Finish Large Dovetail Drawers (includes soft-close undermount guide): ... *GLDDSC(priced per drawer)

*Use for DB30 and DB36 cabinets on the deep drawers only

PREMIER SERIES CABINET SPECIFICATIONS

HANGING RAILS - Wall cabinets have nominal 3/4" thick (18mm) x 3" high multi-ply hardwood plywood or 3/4" thick x 3 7/16" high solid lumber with white laminate. Each is running full cabinet length at the top and bottom. Base cabinets have a nominal 1/2" thick (12mm) x 3" high industrial grade composite panel with maple grained or white laminate at the top.

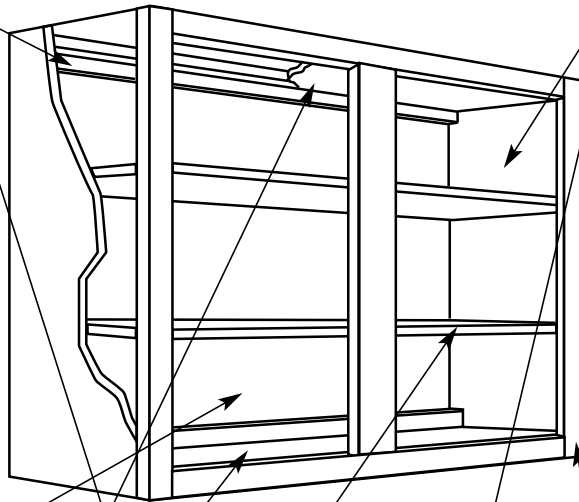

END PANELS -

STANDARD: Nominal 1/2" thick (12mm) industrial grade, wood based composite panel dadoed to receive tops and bottoms, with wood grained or white laminate on exterior surface. Maple grained or white laminate on interior surface. All end panels are inserted into dado in face frame and recessed 3/16".

UPGRADE OPTION: Nominal 1/2" thick (12mm) multi-ply hardwood plywood with oak, maple or cherry veneer on exterior surface and birch veneer on interior surface. All end panels are constructed with the same dado joinery as above and are recessed 3/16".

BACK PANELS - 1/8" Hardboard with maple grained or white interior surface. Securely glued and stapled to end panels and hang rails.

TOP/BOTTOM PANELS - Nominal 1/2" thick (12mm) Industrial grade, wood based composite panel with maple grained or white laminate on exterior and interior surfaces for wall cabinets and interior surface for base cabinets.

SHELVES - Nominal 5/8" thick (15mm) industrial grade wood based composite panel with maple grained or white laminate on both faces and matching edgeband on facing edge. Shelves are adjustable in all standard wall and base cabinets.

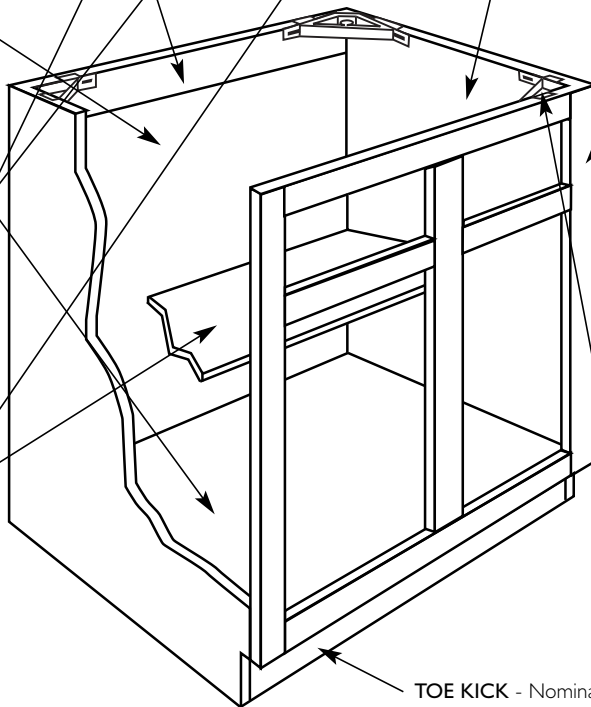

FRONT FRAME - 3/4" Thick kiln dried solid hardwood (wood door styles) or thermofoil vinyl wrapped solid finger jointed lumber or LVL linear veneer lumber (thermofoil and laminate door styles). Mortise and tenon or bore and dowel construction frame joinery reinforced with glue and nail. Stiles 1 1/2" wide. Mulls 3" wide. Rails 1 3/4" wide. Stiles and top and bottom rails dadoed to receive ends, tops and bottoms.

BASE CORNER BRACES - High impact, injection molded plastic.

TOE KICK - Nominal 1/2" thick (12mm) industrial grade, unfinished wood based composite panel captured between end panels.

DRAWERS - (Standard) Front, back and sides are nominal 1/2" thick (12 mm) solid wood. Drawer bottoms are multi-ply hardwood plywood inserted into dado in front, back and sides. All drawer parts glued and stapled together.

DRAWER GUIDES - High quality epoxy coated steel, Cushion-Tec, side mounted guides, self adjusting in mounting brackets. Built-in stop, self-closing and stay-closed features with a 100 lb. rated load capacity.

HINGES - (Standard on all doors) Heavy duty, high quality steel, concealed 6-way adjustable hinge with self-closing feature. (Optional) High quality steel wrap-around hinge with self closing feature (available on standard reveal door styles only).

DOVETAIL DRAWER (Upgrade option) - Front, back and sides are nominal 3/4" thick (19 mm) solid beech hardwood with dovetail

construction. Drawer bottoms are nominal 3/16" (5 mm) multi-ply hardwood birch plywood inserted into dado in front, back and sides. Drawer bottoms are glued and stapled to sides.

UNDERMOUNT DRAWER GUIDE (Standard with dovetail drawer only) - High quality steel, undermount construction provides full drawer access. Self adjusting in mounting brackets. Built-in stop, self-closing and stay closed features with a 75 lb. rated load capacity.

SOFT-CLOSE UNDERMOUNT DRAWER GUIDE (Deluxe upgrade with dovetail drawer only) - High quality steel, undermount construction provides soft-close feature that helps reduce drawer slamming. Drawers are full extension, self adjusting in mounting brackets. Built-in stop, self-closing and stay closed features with a 100 lb. rated load capacity.

PREMIER SPECIFICATIONS



www.armstrong.com

ALLWOOD SPECIFICATIONS

ALLWOOD CABINET SPECIFICATIONS

FRONT FRAME:	3/4" Thick kiln dried solid hardwood. Mortise and tenon or bore and dowel construction frame joinery reinforced with glue and nail. Stiles 1 1/2" wide. Mulls 3" wide. Rails 1 3/4" wide. Stiles and top and bottom rails dadoed to receive ends, tops and bottoms.
END PANELS:	
Standard:	Nominal 1/2" thick (12mm) multi-ply birch veneer plywood dadoed to receive tops and bottoms. End panels are inserted into dado in face frame and recessed 3/16".
Upgrade Option:	Nominal 1/2" thick (12mm) multi-ply hardwood plywood with oak, maple or cherry veneer on exterior surface and birch veneer on interior surface. All end panels are constructed with the same dado joinery as above and are recessed 3/16".
TOP/BOTTOM PANELS:	Nominal 1/2" thick (12mm) multi-ply hardwood plywood. Tops and bottoms set into grooved end panels, front rails and hang rails, glued and stapled. Bottoms are supported at rear of base cabinets by nominal 1/2" thick multi-ply hardwood plywood.
HANGING RAILS:	Wall cabinets have nominal 3/4" thick (18mm) x 3" high multi-ply hardwood plywood, running full cabinet length at the top and bottom. Base cabinets have a nominal 1/2" thick (12mm) x 3" high multi-ply hardwood plywood hang rail at the top.
BACK PANEL:	Nominal 1/8" thick (3mm), hardwood plywood. Securely glued and stapled to end panels and hang rails.
SHELVES:	Nominal 5/8" thick (15mm) multi-ply hardwood plywood, 10 7/8" deep with hardwood veneer banded front edge. Shelves are adjustable in all standard wall and base cabinets.
TOE KICK:	Nominal 1/2" thick (12mm) multi-ply hardwood plywood.
BASE CORNER BRACES:	High impact, injection molded plastic.
DRAWERS: (Standard)	Nominal 1/2" thick (12 mm) solid wood front, back and sides. Drawer bottoms are multi-ply hardwood plywood inserted into dado in front, back and sides. All drawer parts glued and stapled together.
DRAWER GUIDES:	High quality epoxy coated steel, Cushion-Tec, side mounted guides, self adjusting in mounting brackets. Built-in stop, self-closing and stay-closed features with a 100 lb. rated load capacity.
DOVETAIL DRAWER: (Upgrade only)	Front, back and sides are nominal 3/4" thick (19 mm) solid beech hardwood with dovetail construction. Drawer bottoms are nominal 3/16" (5 mm) multi-ply hardwood birch plywood inserted into dado in front, back and sides. Drawer bottoms are glued and stapled to sides.
UNDERMOUNT DRAWER GUIDE: (Standard with dovetail drawer only)	High quality steel, undermount construction provides full drawer access. Self adjusting in mounting brackets. Built-in stop, self-closing and stay closed features with a 75 lb. rated load capacity.
SOFT-CLOSE UNDERMOUNT DRAWER GUIDE: (Deluxe upgrade with dovetail drawer only)	High quality steel, undermount construction provides soft-close feature that helps reduce drawer slamming. Drawers are full extension, self adjusting in mounting brackets. Built-in stop, self-closing and stay closed features with a 100 lb. rated load capacity.
HINGES:	
Standard:	Heavy duty, high quality steel, concealed 6-way adjustable hinge with self-closing feature.
Optional:	High quality steel wrap-around hinge with self closing feature. (Standard reveal door styles only)
FINISH:	Furniture quality protective finish system on doors, drawer fronts, front frames and veneer plywood end panels consisting of sanding, stain, catalyzed sealer and catalyzed clear top coats. All interior end, top, bottom and back panels are finished plywood with clear sealer and top coat.

ALLWOOD UPGRADE NOMENCLATURE

Wall Cabinet with Oak, Maple or Cherry Plywood End Panels:	WOVEP(priced per cabinet)
Base Cabinet with Oak, Maple or Cherry Plywood End Panels:	BOVEP(priced per cabinet)
Tall Cabinet with Oak, Maple or Cherry Plywood End Panels:	TOVEP(priced per cabinet)
Dovetail Drawers (includes undermount guide):	DDU(priced per drawer)
Large Dovetail Drawers (includes soft-close undermount guide):	*LDDU(priced per drawer)
Dovetail Drawers (includes soft-close undermount guide):	DDSC(priced per drawer)
Large Dovetail Drawers (includes soft-close undermount guide):	*LDDSC(priced per drawer)
Glazed Finish Dovetail Drawers (includes soft-close undermount guide):	GDDSC(priced per drawer)
Glazed Finish Large Dovetail Drawers (includes soft-close undermount guide):	*GLDDSC(priced per drawer)

*Use for DB30 and DB36 cabinets on the deep drawers only

*Genuine
ALLWOOD
Cabinetry™*

ALLWOOD CABINET SPECIFICATIONS

HANGING RAILS - Wall cabinets have nominal 3/4" thick (18mm) x 3" high multi-ply hardwood plywood, running full cabinet length at the top and bottom. Base cabinets have a nominal 1/2" thick (12mm) x 3" high multi-ply hardwood plywood hang rail at the top.

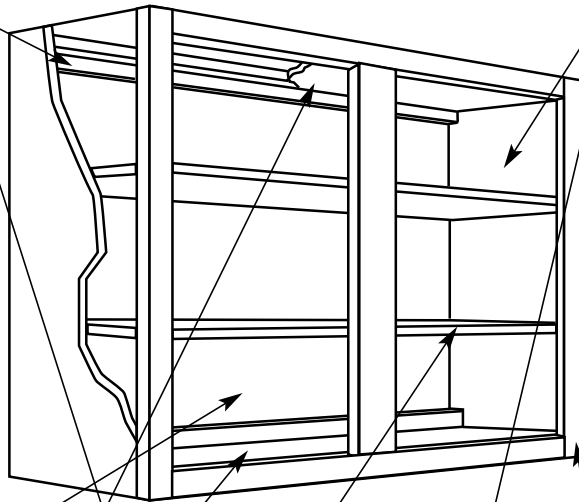

END PANELS -

STANDARD: Nominal 1/2" thick (12mm), multi-ply birch veneer plywood, dadoed to receive tops and bottoms. Ends are inserted into dado in face frame and recessed 3/16".

UPGRADE OPTION: Nominal 1/2" thick (12mm), multi-ply hardwood plywood with oak, maple or cherry veneer on exterior surface and birch veneer on interior surface. All end panels are constructed with the same dado joinery as above and are recessed 3/16".

BACK PANELS - Nominal 1/8" thick (3mm), hardwood plywood. Securely glued and stapled to end panels and hang rails.

TOP/BOTTOM PANELS - Nominal 1/2" thick (12 mm), multi-ply hardwood plywood. Tops and bottoms set into grooved end panels, front rails and hang rails, glued and stapled. Bottoms are supported at rear of base cabinets by nominal 1/2" thick multi-ply hardwood plywood.

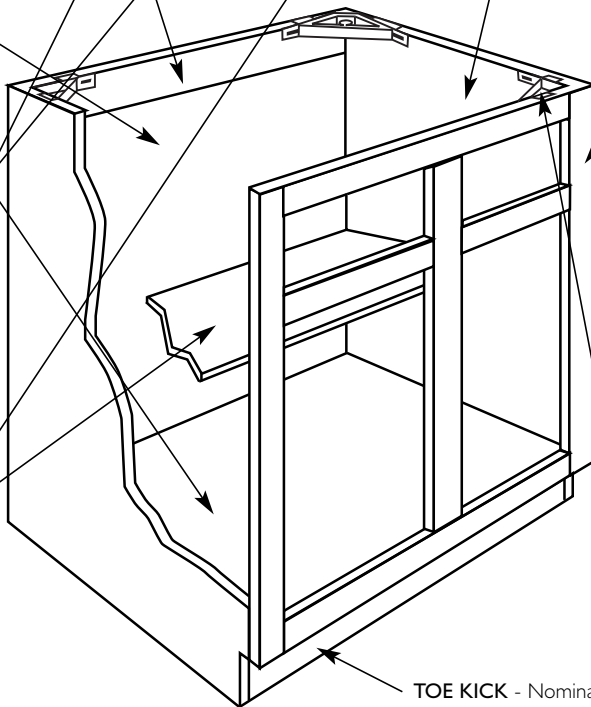

FRONT FRAME - 3/4" Thick kiln dried solid hardwood. Mortise and tenon or bore and dowel construction frame joinery reinforced with glue and nail. Stiles 1 1/2" wide. Mulls 3" wide. Rails 1 3/4" wide. Stiles and top and bottom rails dadoed to receive ends, tops and bottoms.

BASE CORNER BRACES - High impact, injection molded plastic.

SHELVES - Nominal 5/8" thick (15 mm), multi-ply hardwood plywood, 10 7/8" deep with hardwood veneer banded front edge. Shelves are adjustable in all standard wall and base cabinets.

TOE KICK - Nominal 1/2" thick (12mm), multi-ply hardwood plywood.

DRAWERS - (Standard) Front, back and sides are nominal 1/2" thick (12 mm) solid wood. Drawer bottoms are multi-ply hardwood plywood inserted into dado in front, back and sides. All drawer parts glued and stapled together.

DRAWER GUIDES - High quality epoxy coated steel, Cushion-Tec, side mounted guides, self adjusting in mounting brackets. Built-in stop, self-closing and stay-closed features with a 100 lb. rated load capacity.

HINGES - (Standard on all doors) Heavy duty, high quality steel, concealed 6-way adjustable hinge with self-closing feature. (Optional) High quality steel wrap-around hinge with self closing feature (available on standard reveal door styles only).

DOVETAIL DRAWER (Upgrade option) - Front, back and sides are nominal 3/4" thick (19 mm) solid beech hardwood with dovetail

construction. Drawer bottoms are nominal 3/16" (5 mm) multi-ply hardwood birch plywood inserted into dado in front, back and sides. Drawer bottoms are glued and stapled to sides.

UNDERMOUNT DRAWER GUIDE (Standard with dovetail drawer only) - High quality steel, undermount construction provides full drawer access. Self adjusting in mounting brackets. Built-in stop, self-closing and stay closed features with a 75 lb. rated load capacity.

SOFT-CLOSE UNDERMOUNT DRAWER GUIDE (Deluxe upgrade with dovetail drawer only) - High quality steel, undermount construction provides soft-close feature that helps reduce drawer slamming. Drawers are full extension, self adjusting in mounting brackets. Built-in stop, self-closing and stay closed features with a 100 lb. rated load capacity.

ALLWOOD SPECIFICATIONS

Genuine
ALLWOOD
Cabinetry™

www.armstrong.com

EXTREME SPECIFICATIONS

EXTREME DOOR STYLE AVAILABILITY:

OAK

Branford
Hampton
Hampton Arch

PLANTATION HARDWOOD

Bali
Coronet

BIRCH

Siena
Tuscany

MAPLE

Berkshire
Berkshire Arch
Caruth
Rutledge

FINISH AVAILABILITY:

OAK

Chestnut
Honey
Mocha

PLANTATION HARDWOOD

Chestnut
Honey
Mocha

BIRCH

Toffee

MAPLE

Mocha
Toffee

EXTREME SERIES CABINET SPECIFICATIONS

FRONT FRAME: 3/4" Thick kiln dried solid hardwood. Mortise and tenon or bore and dowel construction frame joinery reinforced with glue and nail. Stiles 1 1/2" wide. Mulls 3" wide. Rails 1 3/4" wide. Stiles and top and bottom rails dadoed to receive ends, tops and bottoms.

END PANELS:

Standard: Nominal 1/2" thick (12mm), multi-ply Type I exterior glue hardwood plywood, dadoed to receive tops and bottoms. Ends are inserted into dado in face frame and recessed 3/16" and rabbeted to receive backs.

Upgrade Option: Nominal 1/2" thick (12 mm), multi-ply hardwood plywood with oak veneer on exterior surface and birch veneer on interior surface. All end panels are constructed with the same joinery as noted above.

TOP/BOTTOM PANELS: Nominal 1/2" thick (12 mm), multi-ply hardwood plywood. Tops and bottoms let into end panels, front rails and hang rails, glued and stapled. Bottoms are supported at rear of base cabinets by nominal 1/2" thick multi-ply hardwood plywood.

HANGING RAILS: Wall cabinets: nominal 3/4" thick (18 mm) x 3" high multi-ply hardwood plywood, running full cabinet length at the top and bottom. Base cabinets: nominal 3/4" thick (18 mm) x 7 1/4" high solid pine at the top. All hang rails are rabbeted to inset in end panels and to receive backs.

BACK PANEL: Nominal 1/4" thick (5.2 mm), hardwood plywood. Securely glued and stapled to rabbets in end panels and hang rails.

SHELVES: Nominal 1/2" thick (12 mm), multi-ply hardwood plywood, 10 7/8" deep with hardwood veneer banded front edge. Shelves are fixed into dadoes in end panels on all cabinets.

TOE BOARD:

Standard: Nominal 3/4" thick (18 mm), ACQ* pressure treated toe board captured between end panels.

Upgrade Option: 3-sided ACQ* pressure treated toe board attached inside end panels, with same specifications as above.

BASE CORNER BRACES: Two 3/4" x 1 1/2" solid hardwood or hardwood plywood corner braces running full depth front to back of cabinet. All braces are glued and pinned at top of cabinet to front frame, rear hanging rails and end panels.

DRAWERS: 1 1/16" thick solid pine lumber four sided drawer box. Ends are captured in drawer side dadoes. Drawer bottoms are nominal 1/4" thick (5.2 mm) hardwood plywood dadoed into all four drawer box sides. All drawer parts are glued and stapled together.

DRAWER GUIDES: High quality epoxy coated steel, Extreme grade, side mounted guides, self adjusting in mounting brackets. Mounting brackets are screwed to solid pine back hanging rails. Built-in stop, self-closing and stay-closed features with a 100 lb. rated load capacity.

HINGES:

Standard: High quality steel wrap-around hinge with self closing feature. (Standard reveal door styles only).

Optional: Heavy duty, high quality steel, concealed 6-way adjustable hinge with self-closing feature. (Not available on Traditional birch door)

FINISH: Furniture quality protective finish system on doors, drawer fronts, front frames and veneer end panels consisting of sanding, stain, catalyzed sealer and catalyzed clear top coats. All interior end, top, bottom and back panels are finished plywood with clear sealer and top coat.

DOOR STYLE: See color brochure for availability.

EXTREME SERIES UPGRADE NOMENCLATURE

Wall Cabinet with Oak Veneer Plywood End Panels: WOVEP (price per cabinet)
Base Cabinet with Oak Veneer Plywood End Panels: BOVEP (price per cabinet)
Tall Cabinet with Oak Veneer Plywood End Panels: TOVEP (price per cabinet)

*Toe Board is made of "ACQ" Alkaline Copper Quaternary pressure treated lumber meeting AWPA Standard C2. The EPA awarded its "Presidential Green Chemistry Challenge Award" to Chemical Specialties, Inc. the developer of ACQ, an industry leader in non-arsenic wood preservatives.

EXTREME SERIES CABINET SPECIFICATIONS

HANGING RAILS -

Wall cabinets: nominal 3/4" thick (18 mm) x 3" high multi-ply hardwood plywood, running full cabinet length at the top and bottom. Base cabinets: nominal 3/4" thick (18 mm) x 7 1/4" high solid pine at the top. All hang rails are rabbeted to inset in end panels and to receive backs.

BACK PANELS -

Nominal 1/4" thick (5.2 mm), hardwood plywood. Securely glued and stapled to rabbets in end panels and hang rails.

TOP/BOTTOM PANELS -

Nominal 1/2" thick (12 mm), multi-ply hardwood plywood. Tops and bottoms let into end panels, front rails and hang rails, glued and stapled. Bottoms are supported at rear of base cabinets by nominal 1/2" thick multi-ply hardwood plywood.

SHELVES - Nominal 1/2" thick (12 mm), multi-ply hardwood plywood, 10 7/8" deep with hardwood veneer banded front edge. Shelves are fixed into dados in end panels on all cabinets.

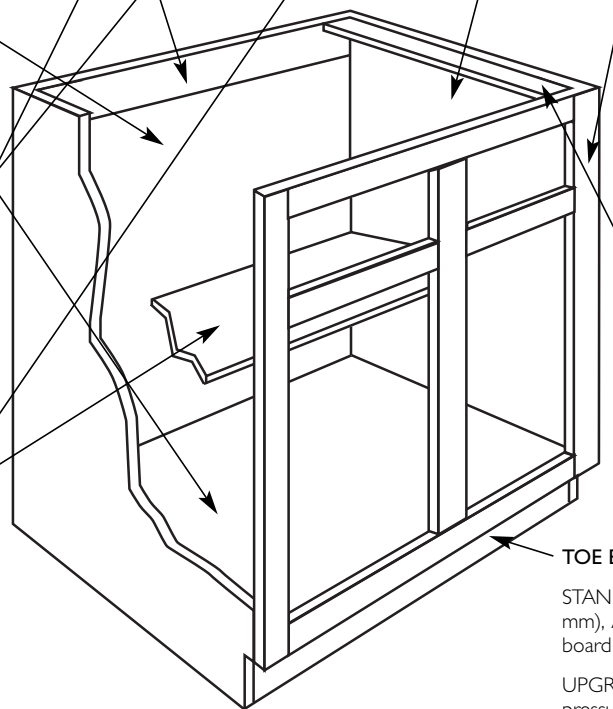
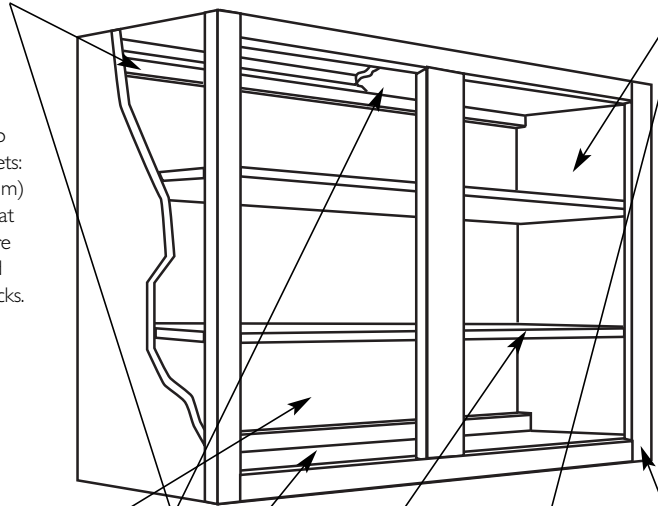

END PANELS -

STANDARD: Nominal 1/2" thick (12 mm), multi-ply Type 1 exterior glue hardwood plywood, dadoed to receive tops and bottoms. Ends are inserted into dado in face frame and recessed 3/16" and rabbeted to receive backs.

UPGRADE OPTION: Nominal 1/2" thick (12 mm), multi-ply hardwood plywood with oak veneer on exterior surface and birch veneer on interior surface. All end panels are constructed with the same joinery as noted above.

FRONT FRAME - 3/4" thick kiln dried solid hardwood. Mortise and tenon or bore and dowel construction frame joinery reinforced with glue and nail. Stiles 1-1/2" wide. Mulls 3" wide. Rails 1-3/4" wide. Stiles and top and bottom rails dadoed to receive ends, tops and bottoms.

BASE CORNER BRACES - Two 3/4" x 1 1/2" solid hardwood or hardwood plywood corner braces running full depth front to back of cabinet. All braces are glued and pinned at top of cabinet to front frame, rear hanging rails and end panels.

TOE BOARD -

STANDARD: Nominal 3/4" thick (18 mm), ACQ* pressure treated toe board captured between end panels.

UPGRADE OPTION: 3-sided ACQ* pressure treated toe board attached inside end panels, with same specifications as above.

DRAWERS - 1 1/16" thick solid pine lumber four sided drawer box. Ends are captured in drawer side dados. Drawer bottoms are nominal 1/4" thick (5.2 mm) hardwood plywood dadoed into all four drawer box sides. All drawer parts are glued and stapled together.

DRAWER GUIDES - High quality epoxy coated steel, Extreme grade, side mounted guides, self adjusting in mounting brackets. Mounting brackets are screwed to solid pine back hanging rails. Built-in stop, self-closing and stay-closed features with a 100 lb. rated load capacity.

HINGES - Standard – High quality steel wrap-around hinge with self closing feature (standard reveal doors only).

Optional – Heavy duty, high quality steel, concealed 6-way adjustable hinge with self-closing feature.

(Not available on Traditional birch door).

EXTREME SPECIFICATIONS

EXTREME DOOR STYLE AVAILABILITY:

OAK
Branford
Hampton
Hampton Arch

PLANTATION HARDWOOD
Bali
Coronet

BIRCH
Siena
Tuscany

MAPLE
Berkshire
Berkshire Arch
Caruth
Rutledge

FINISH AVAILABILITY:

OAK
Chestnut
Honey
Mocha

PLANTATION HARDWOOD
Chestnut
Honey
Mocha

BIRCH
Toffee

MAPLE
Mocha
Toffee

extreme
SERIES

www.armstrong.com

W 30 42

Wall Cabinet —↑ 30" Width —↑ 42" Height

CW S 24 30 L or R

Corner Wall Cabinet —↑ Lazy Susan —↑ 24" Width Ea. Direction —↑ 30" Height —↑ Left or Right Door Hinge

BL PW 27/30 42 L or R

Blind Cabinet —↑ Peninsula Wall —↑ 27"-30" Width —↑ 42" Height —↑ Left or Right Door Hinge

B 27 ST4

Base Cabinet —↑ 27" Width —↑ With 4 Shelf Trays

B SQC 36 L or R

Base Cabinet —↑ Square Corner —↑ 36" Width —↑ Left or Right Door Hinge

UC 18 12 x 96 L or R

Utility Cabinet —↑ 18" Wide —↑ 12" Deep —↑ 96" Height —↑ Left or Right Door Hinge

VS DB 18

Vanity Cabinet —↑ 18" Deep —↑ Drawer Base —↑ 18" Wide

V 48

Vanity Cabinet —↑ 21" Deep —↑ 48" Wide