

CABINET SPECIFICATION

WALL CABINET

- A** 5/8" thick material, dowel And glue construction.
- B** 3/4" fully adjustable shelves, For extra strength.
- C** 1/4" back panel is routed Into all 4 sides of cabinet To ensure it is square.
- D** 4½" X 5/8" thick Hanging rails.
- E** Top and bottom of end Panels are edge banded.

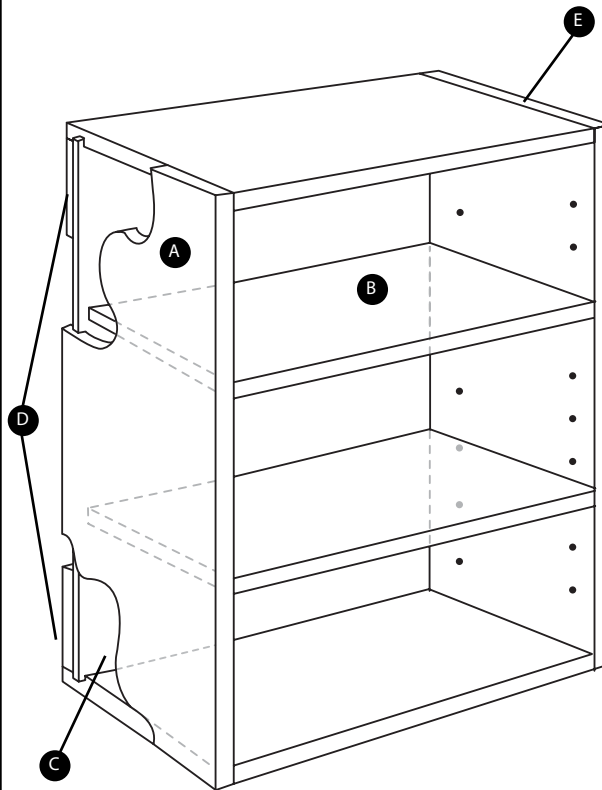

BASE CABINET

- F** 5/8" thick material, dowel And glue construction.
- G** 3/4" thick 13" deep Fully adjustable shelves, For extra strength.
- H** 1/4" back panel is routed Into all 4 sides of cabinet To ensure it is square.
- I** A 5/8" thick X 4½" Back toe kick is designed To add support to bottom Of cabinet while preventing Side panels from breaking at The corner when in transit.
- J** A 5/8" thick X 4½" nailer On top of base cabinet for Easier installation.
- K** 5/8" thick front and back Horizontal cross braces for Maximum strength and For easier counter top Installation.
- L** 5/8" thick X 4½" toe kick.

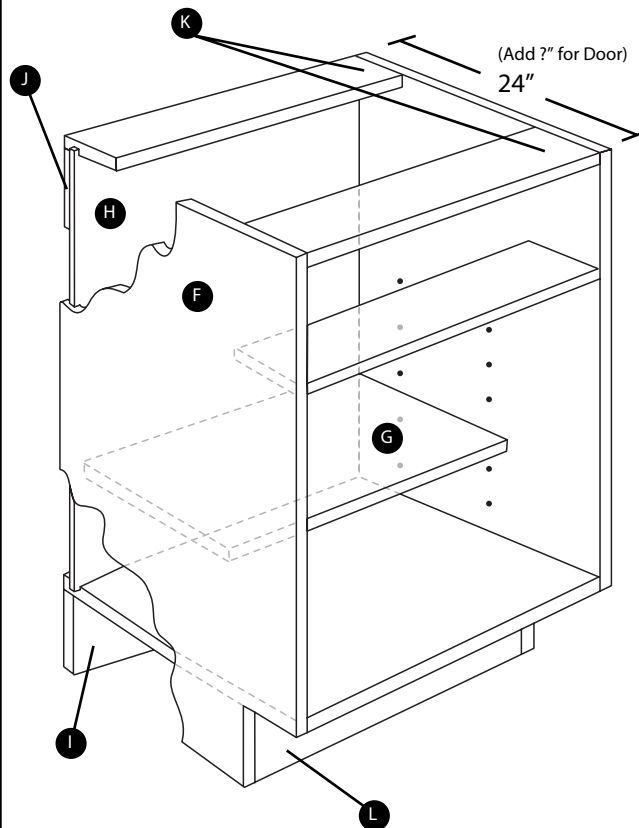

DELUXE

Furniture grade, wood based Composite panels.

White / wood grain interior.

110 ° clip on 6 way Adjustable hinge.

Metal box drawer with 5/8" Thick back and bottom.

Base cabinet upgrades, Full shelves / pull out shelves.

CLASSIC

5 ply multi core plywood.

White / wood grain interior.

110 ° clip on 6 way Adjustable hinge.

Metal box drawer with 5/8" Thick multi core plywood Back and bottom.

Base cabinet upgrades, Full shelves / pull out shelves.